

# Barnaamijka Buundada Galbeedka Seattle Kulan dadweyne muuqaal ah

Juulay 21, 2021



City of Seattle



Español  
Tiếng Việt  
普通話

Audio Settings

Chat

Raise Hand

Q&A

Closed Caption

Interpretation

Leave

# Hubinta in kulanku laga qeyb gali karo

- Sanduuqa wada sheekeysiga iyo kaamerada looma awoodsiin ka qeyb
- Waxad ku soo gudbin kartaa su'aalahaaga muddada kulanku socdo sanduuqa Q&A ee shaashadda hoosteeda ka muuqda.
- Xilliga Q&A, waxad isticmaali kartaa muuqaalka gacanta si aad u su'aashaada si cod dheer ah ugu weydiiso.
- Waxad heysataa 45 ilbiriqsi si aad su'aashaada u weydiisato
- Marin gaaban ee softiweerka shaashad aqriyaha waxa ka mida
  - Alt + Y si aad kor ugu qaaddo ama hoos ugu dhigto gacantaada.
  - Alt + A si aad u aamusiso and codka ugu furto

# Agenda

- Dulmarka war soo jeedinta
  - Wararka dheeriga dayactirka ku saabsan
  - Isticmaalidda buundada hoose
  - Dib ugu xiranka Galbeedka Seattle
  - Joog xaafadda oo qorsheyso goor hore daraasadda beddelista Buundada
- Qeybta S&J ama Q&A
- Kulanka waa inoo xiran yahay



# Waad ku mahadsan tahay dulqaadkiina joogtada ah

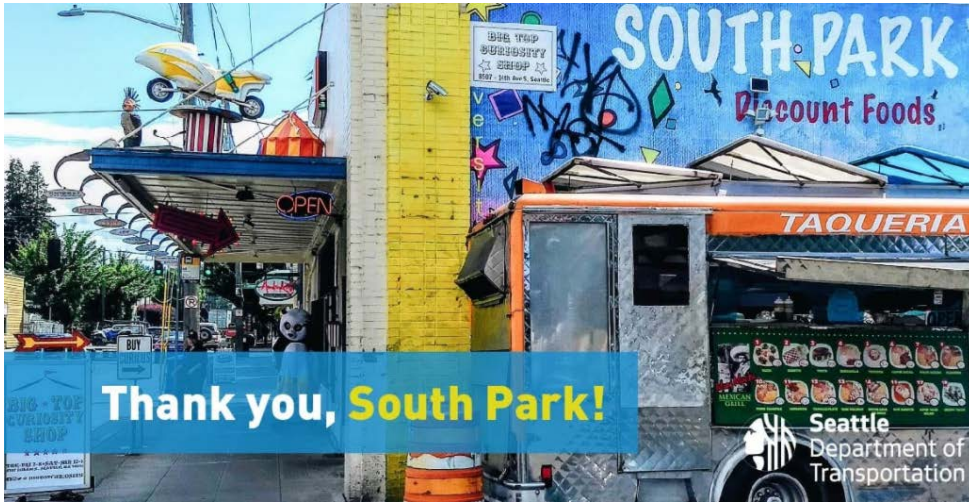

Question and Answer

### Welcome to Q&A

Questions you ask will show up here. Only host and panelists will be able to see all questions.

Type your question here...





# Polls

# Wararkii ugu dambeeyey dayactirka

Heather Marx, SDOT  
Juulay 21, 2021



City of Seattle



# Maxaa ku dhacay buundada sare?

- Buundadu waxey xirneyd ilaa Maarso 2020 ka dib markii dildilaacyo soo kordhaya laga helay dhismaha xilli lagu jiray baaritaanno caadi ah.
- Dildilaacyada waxa suurto gal ah iney sababeen dabacsanaan ku timid kaawooyinka isku haya buundada eemarkii hore lagu dhisay.
- Kaawooyinka dhismaha ka dib lagu taagay waa xargo dhuujinaya buundada xoojinaya sagaxadda shamiitada. Buundada waxa lagu dhisay heerka tayada maalinkaa
- Wax habacsanaan gaar ah ama qalad kale laguma arkin eegitaankeeni naqshadda iyo nuqullada dhismaha
- Waxan durba ku dhaqaaqnay shaqo deg-deg ah oo lagu xasilinayo, taasi oo si guul ah u hakisay dildilaacyadii soo badanayey iyadoo buundadiina ku sii heysay iney sii taagnaato.



# Dayactir: Waddada ugu deg-deg badan ee dib loogu furay

- Waxan ognahay in xiritaanka buundadu ay caqabado ku keentay bulshada Galbeedka Seattle iyo Duwamish Valley.
- Nofember, Mayor Durkan waxey ku dhawaaqday in buundadu la dayactiri doono imika iyo in la beddeli doono mustaqbalka.
- Dayactirka waa jidka ugu dhaqsiyaha badan ee dib loogu soo celin karo socodka lagu tagayey Galbeedka Seattle
- Buundadu waxey ku socotaa in dib loo furo bartamaha 2022



# Buundadu waxey ku socotaa in la furo bartamaha 2022



Ku lug lahaanshaha dadweynaha

# Ousbooneysiin dayactirka buundada

## Waxa aannu sameynay:

- ✓ Waxan xaqiijinnay maal-gelintii
- ✓ Indho ku heyn lagu hayey buundada si la isugu wargeliyo dayactirro dheeraad ah
- ✓ Kontoraadle dhismaha oo la xushay:
- ✓ Kraemer North America
- ✓ Sida ay qabto USDOT inuu awoodo inuu isticmaali karo heshiiska bulshada ee Xoogga Shaqada si uu u shaqo siiyo shaqaalaha sib koodyada fursaduhu ku yar yihiin
- ✓ Waxey gaartay halka dhexe ee naqshadda cirifkeeda laga gaaro bishan

## Maxaa xiga:

- La dhammeystirka dayactirka naqshadda kama dambeysta deyrta
- Wejiga 2 (dib usoo nooleyn) dhismaha si loo bilaabo sannadkan dhammaadkiisa.
- Buundadu waxey ku taagan tahay jadwalka dib u furitaanka bartamaha 2022



Xasilintii hore ee buundada sare waxa dhameystiry Kraemer North America dhamaadka 2020, kaasi oo hoggaamin doona wejiga 2 ee shaqada (dib usoo nooleynta).

# Goorma ayenu arkeynaa dad ku dul shaqeynaya buundada?

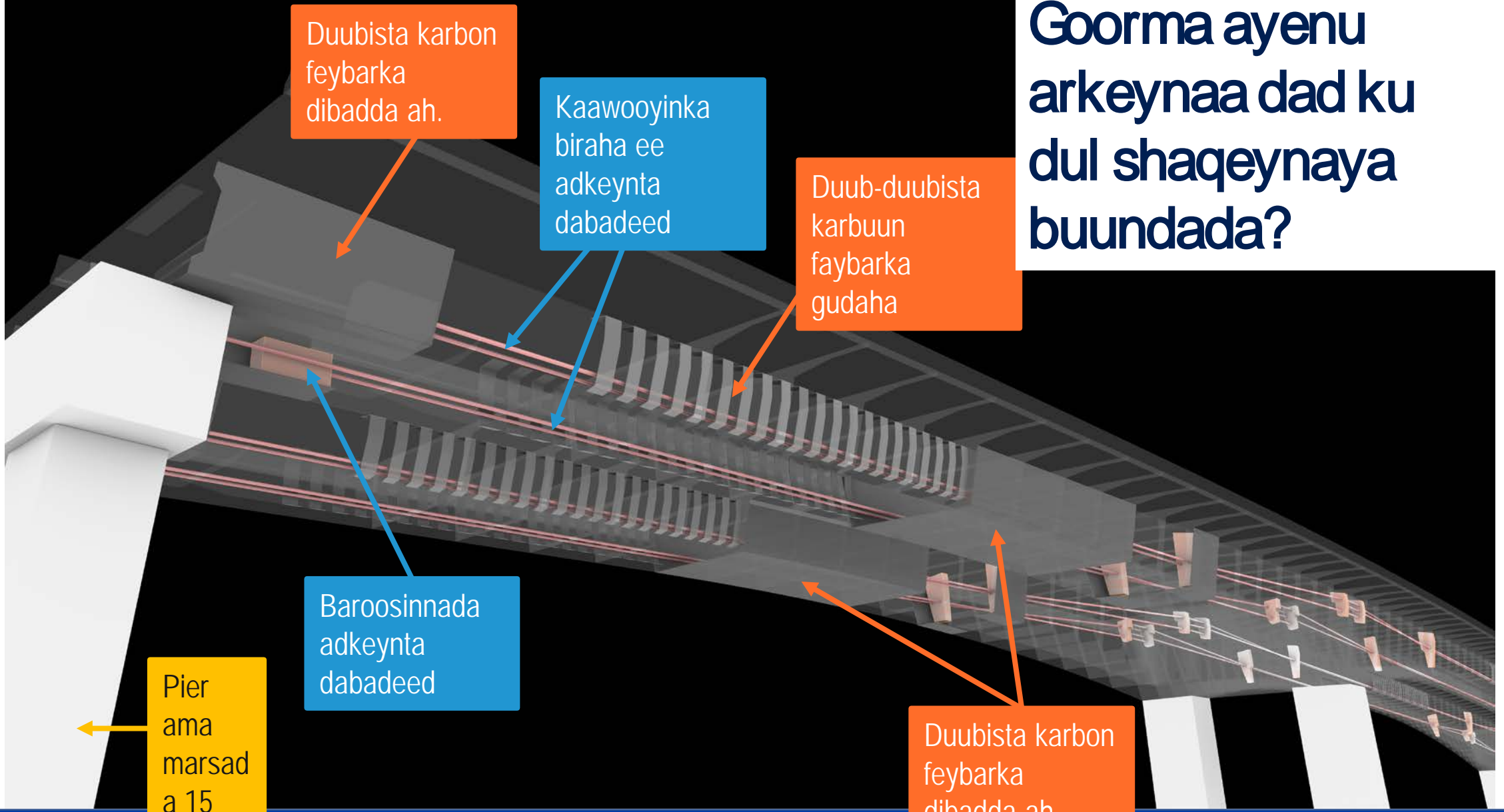

# Isticmaalidda buundada hoose

Maureen Sheehan, SDOT  
Juulay 21, 2021



City of Seattle

# Buundada Spokane St Swing Bridge (Buundada Hoose)

- Xiritaanka buundada sare waxey sababtay lumitaanka 7 leen oo lagu tago ama looga yimaado Galbeedka Seattle
- Buundada hoose waa mid ka mida isku xirayaasha – laakinse waxa kaliya ee ay qaadi kartaa 1/5 baaburtii buundada sare
- Buundada hoose u furintaankeeda maraakiibta badda waxey sii adkeyneysaa tirada baabuurta ee isticmaali karta buundada
- Soo koobidda socodka baabuurta ee buundada hoose waa lagama maarmaan si loo hubiyo in gaadiidka gurmada deg-degga ah ay mari karaan.
- Adkeynta maanta saaran waxey mudnaanta siineysaa socod waqtiyeysan oo nabad ah ee baabuurta gurmada deg-degga ah ku maraan, basaska, iyo xamuulka

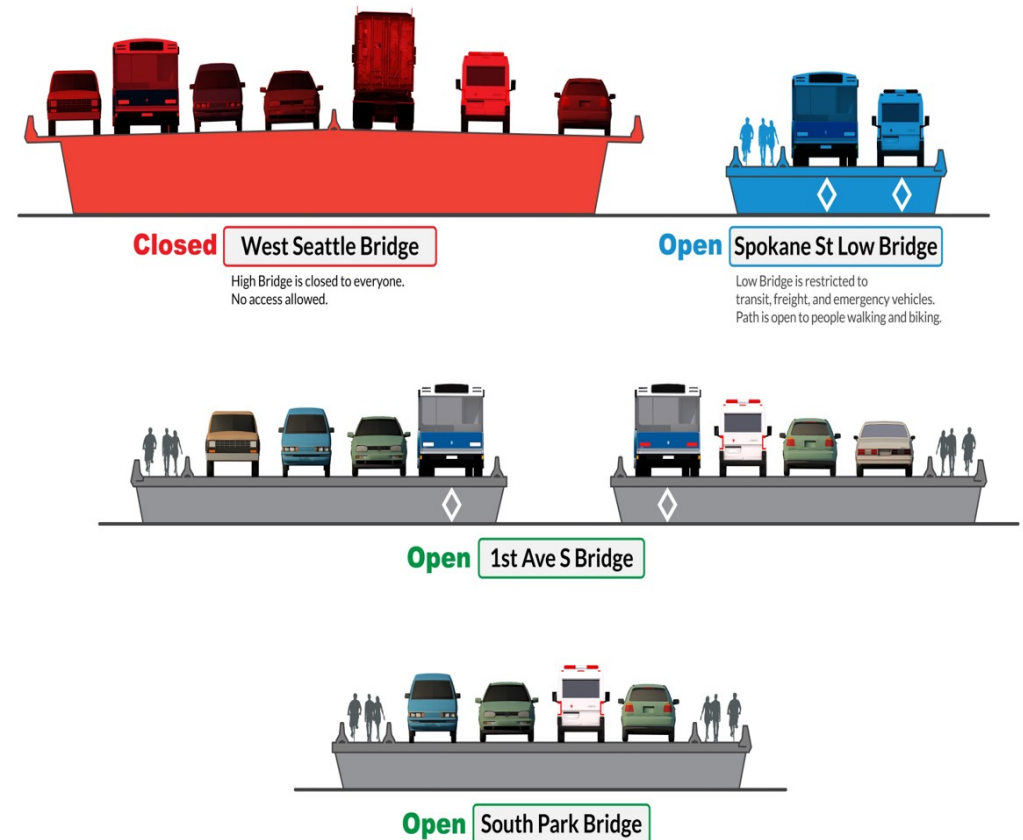

# Hoos ha aadin!

- 75 doolar tikid ah mar kasta oo aad ku dul waddo buundada hoose adigoon oggolaansho u heysan saacadaha la xadiday.
- Saacadaha la xaddiday waa 5-ta subax ilaa 9-ka galab maalmaha dhamaadka toddobaadka (Sabti iyo Axad)



## XUSUUSIN

- Waxanu u baahan nahay inaanu buundada hoose u firaqeyno baabuurta gurmada deg-degga ah, basaska iyo xamuulka.
- Buundada hoose mar kasta waxey u furan tahay dhammaan socodka, baaskiileynta, ama orodka.



# Yaa isticmaali kara buundada hoose?



Socod iyo baaskiileyn mar kasta waa loo oggol yahay buundada hoose

**Waxey siineynay maritaanno ku meel gaar ah qaar ka mida socotada ee safarrada deg-degga een qorsheysneyn ku marayaan buundada hoose ka dib markii ay soo codsadeen loona oggolaaday:**

- Dadka helaya daaweyn lagu badbaadinayo nolol
- Shaqaalaha wicitaanka ku shaqeeya
- Maqaayadaha ku yaalla Galbeedka Seattle iyo ganacsiyada tafaariiqda
- Ganacsiyada Xeebaha/Warshadaha International Longshore iyo Xubnaha
- Warehouse Union (ILWU) marka loo diro ka gudubka Duwamish
- Socdaallada Dowladda (Magaalada Seattle, Dekedda Seattle, King County, Gobolka Washington, hey'adaha Federaalka, iwm.)

**Dhammaan socotadaasi waa iney codsadaan, muujiyaan iney buuxiyeen shuruudaha iyo iney ka helaan oggolaansho SDOT ka hor isticmaalka buundada.**

Ma kula tahay inaad buuxisay shuruudaha? Ka codso maritaanka [www.seattle.gov/transportation/lowbridge](http://www.seattle.gov/transportation/lowbridge)

# Marit aanka buundada hoose wuxuu isbeddelayaa horraant a 2022



- Waxa jiri doona maritaan ku meel gaar ah Janaayo 2022 oo ganacsatada iyo socdaallada caafimaad ku kooban
- Dekedda 5 dib ayey u furmi doontaa, iyadoo ku keeneysa gaadiidka xamuullada oo badan buundada hoose maalintii
- Imissa ayaa maritaankoodu hoos u dhacayaa? SDOT waxey ka fakareysaa:
  - Imisa baabuur ayey buundadu qaadi kartaa saacaddii
  - Sidee bay baabuurta dhaqsi ugu firaaqeyn karaan marka buundadu u furmeyso maraakiibta badda
  - Macluumaad Sahan laga sameeyey isticmaalayaasha imika

# Tallaabooyinka Xiga

- Waxan sidii wadi doonnaa inaan isha ku heynto mugga qaadka buundada hoose
- Waxanu sii wadi doonnaa inaan ku shaqeyno waxanu aanu ka maqalnay bulshada oo ku saabsan maritaanka ugu faa'iido badan
- Waxanu sii wadi doonnaa inaan la wadaagno wararka ku saabsan isbeddelka ku jeeda maritaanka buundada hoose. Kala soco wararkii ugu dambeeyey adigoo webseydkeena isku qoraya si aad u hesho digniinaha.



# Poll

# Dib-ugu-xiranka Galbeedka Seattle

Sara Zora, SDOT  
Juulay 21, 2021



City of Seattle

# Saameynta xiritaanka buundada hoose

Xiritaanka buundada wuxuu qof kasta ku yeeshay saameyn ballaaran

- Wuxuu kordhiyey saxmaddii iyo waqtigii safarka
- Xawaareyn iyo khatar amaanka ah
- Saameyn bey'adda iyo caafimaadka ah

Saameyn gaar ahaan ku adag South Park, Highland Park iyo Georgetown

-bulshooyinka ku teedsan waddooyinka lagu leexo waxey la kulmaan baabuur badan oo xaafadaha dhex marta

Saameynta xiritaanka buundada waxey si aan qiyaas laheyn u dareemaya bulshada midabka leh iyo kuwa reer Seattle ee dakhligoodu hooseeyo .

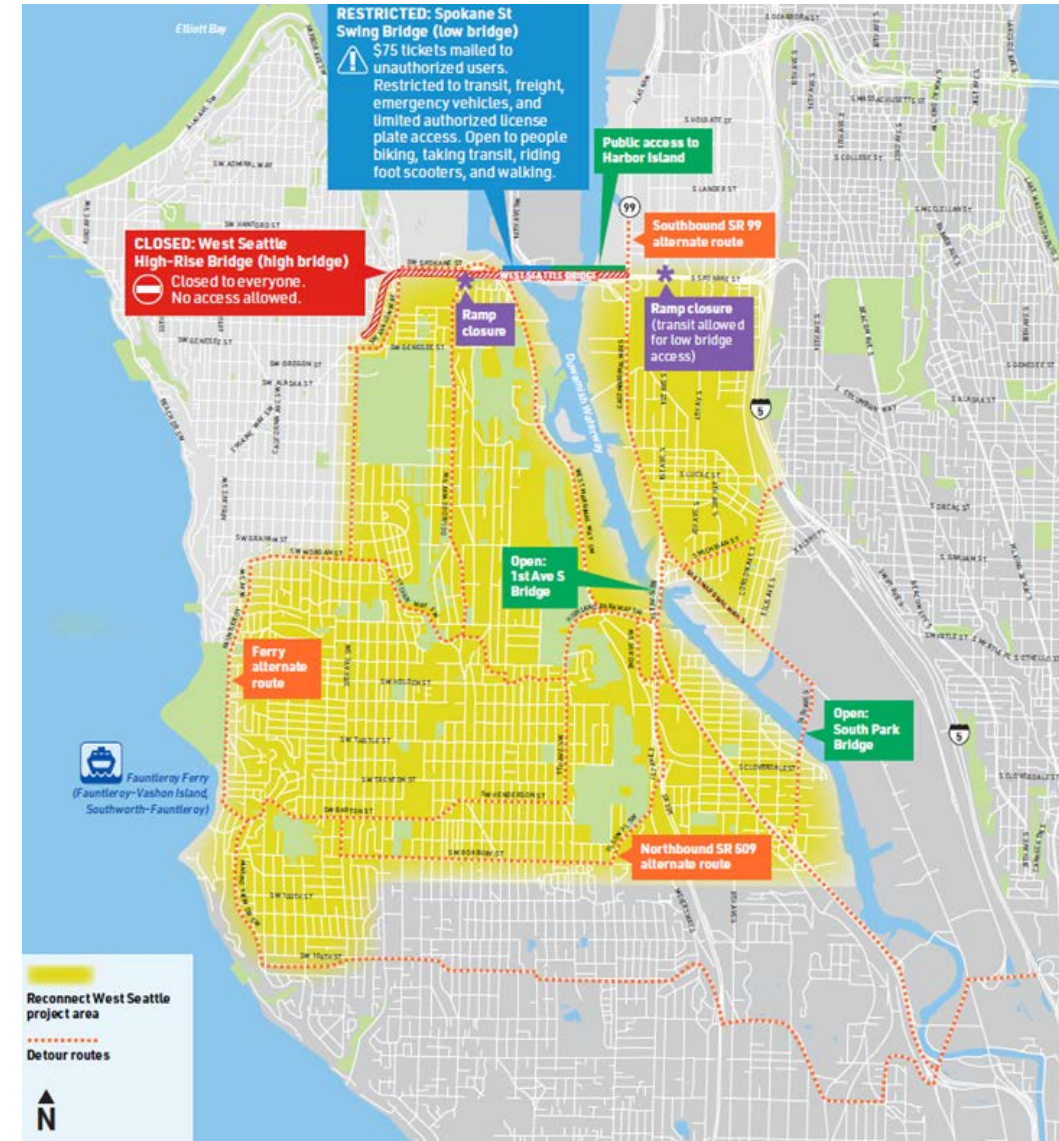

# Hagaajinno lagu caawinayo fudueynta saameynta

- In ka badan 200 mashaariic socodka baabuurta ah ayaa la dhameystiray si gacan looga geysto yareynta ciriiriga iyo kordhinta amniga
- Si joogto dib loogu eegayo waqtiga nalalka biligleeya, calaamadaha, iyo wararka waqtiga saxda ah
- Fulinta mashaariicda bulshada soo xulatay

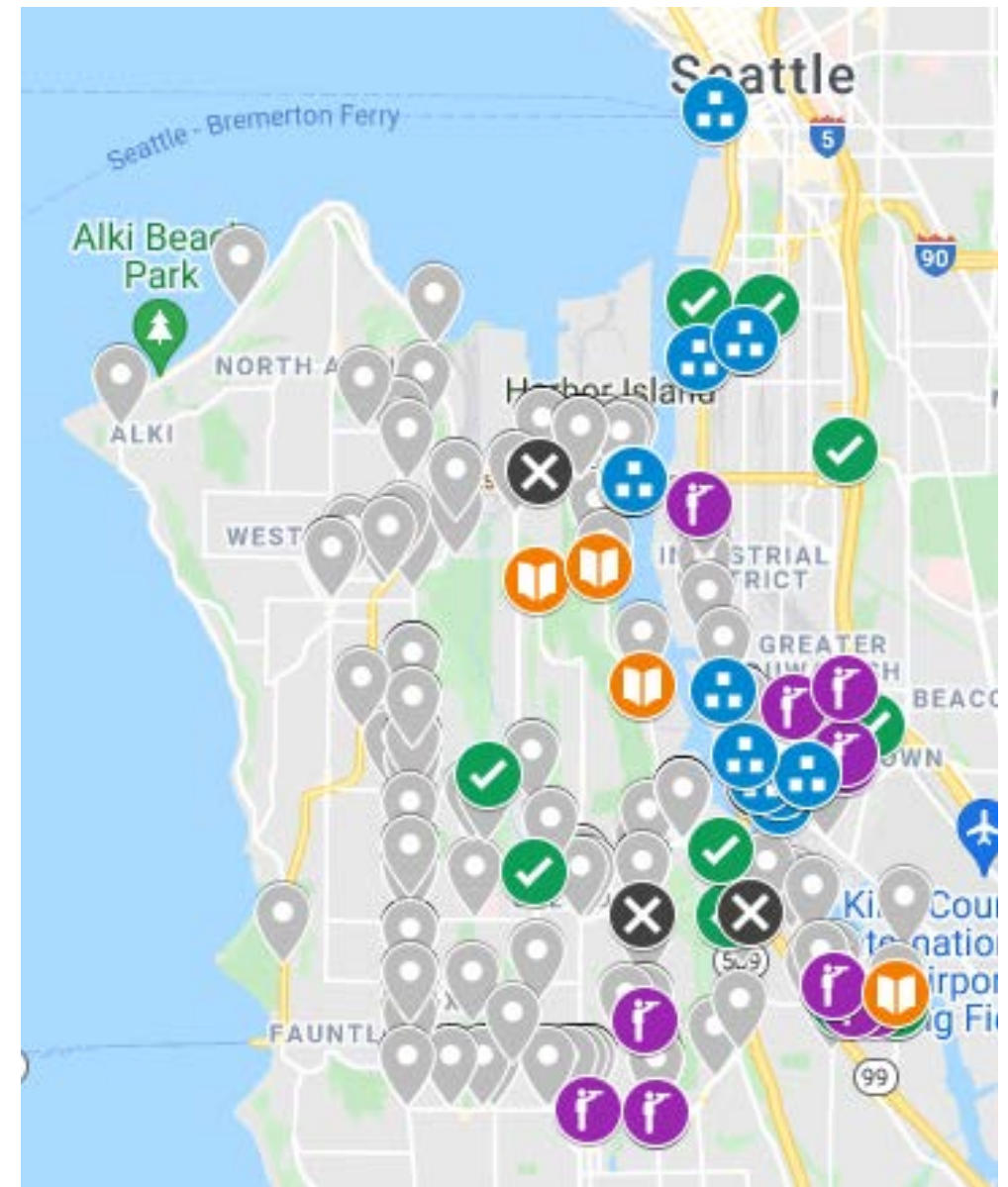

# Home Zones

Yareynta xawaaraha baabuurta iyo waddooyin badan oo lagu lugeyn karo iyadoo lagu soo kordhinayo:

- Buraha xawaaraha
- Socodka goynta jidka
- Nooleyn iyo qurxin

Xaafadaha sida ba'an ay u saameysay leexashada baabuurta:

- South Park
- Highland Park
- Georgetown





# Hagaajinnada West Marginal Way SW

Mashaariicda la dhameystiray

- Calaamado xadidaya xawaaraha 30 meyl saacadii iyo raadaar ka soo warbixiya calaamadaha
- Waddo-socodka dhinaca galbeed Duwamish Longhouse

Dhismaha deyrta 2021 soo socda:

- Calaamadaha nalalka ku meel gaarka ee waddo goynta Duwamish Longhouse
- Calaamadeynta jidadka loogu leexo ganacsiyada si ay u furnaadaan

In la dhiso ka dib marka Buundada Galbeedka Seattle dib u furanto:

- Labo leen baaskiil oo la dhowro iyo gaari dhigasho jidka dhinaciisa.



# Hagaajinnada aagga West Marginal Way iyo Highland Park Way

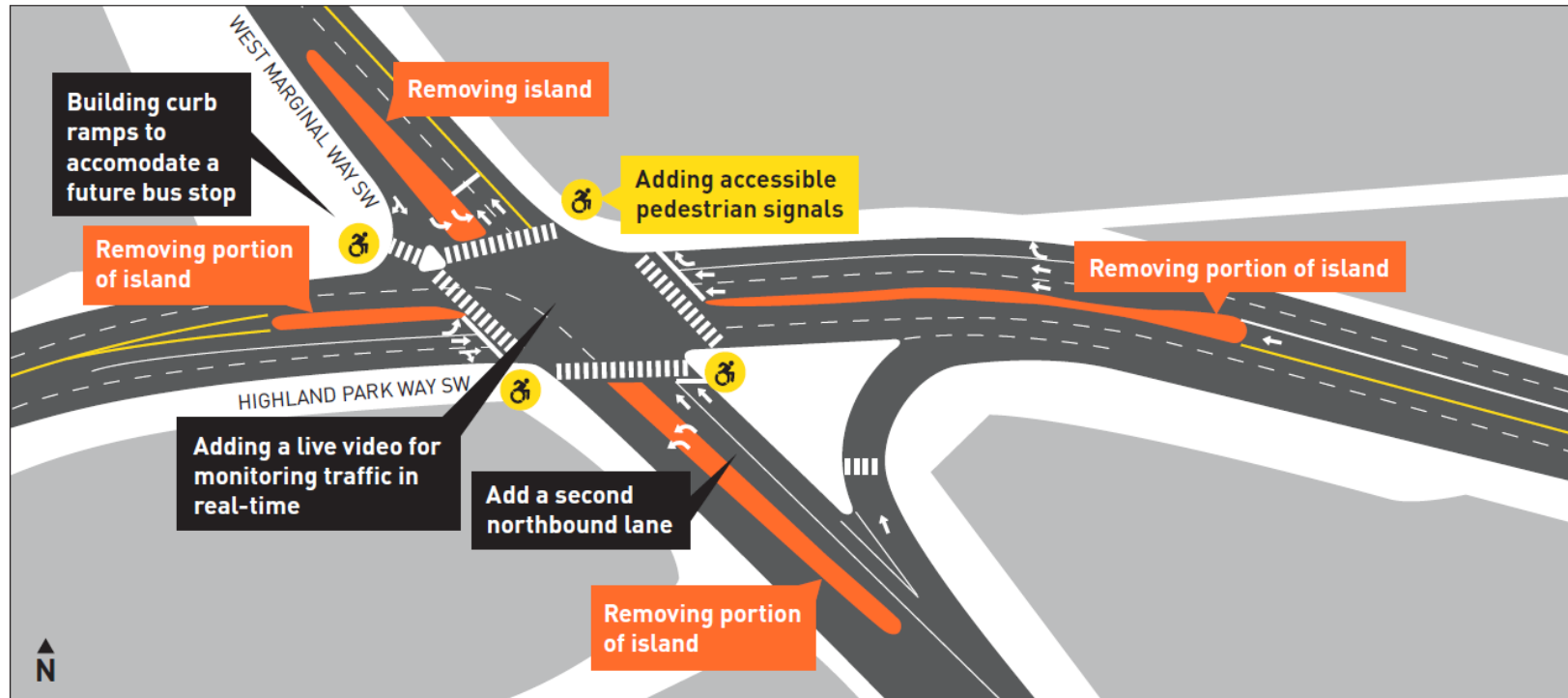

- Dhismuhu wuxuu bilowday Juulay 17 si loo hagaajiyo socodka baabuurta
- Saameynta ugu yar ay ku leedahay baabuurta (siiba dhamaadka toddobaadka; wuxuu bilaabanayaa ugu horreyn 3-da aroornimo)
- Taariikhda la filayo in la dhameystiro: Sebtember 30

# Ka qeyb ka ahow kuw ka soo jawaaba! Joog xaafadda horena u qorsheyso

Sara Zora, SDOT  
Juulay 21, 2021



City of Seattle

# Hal sano oo dheeri ah ayaa harsan

- Waxan heysannaa qiyaas hal sano oo u dhaxeeya qaadista xirnaashihii COVID-19 iyo dib u furista buundada sare
- Haddii aan dhammaan ku wadno buundada lagu leexo si la mida sida aan ugu wadnay buundada sare COVID-19 ka hor, buundooyinka ku leexayadu waxey helayaan baabuur ilaa labo jabbaar ku ah inta ay xamili karaan
- Aannu ka fogaanno inaannu heerkaa baabuurta ciriirigooda ah gaarno iney wada shaqeyneyna



Seattle  
Department of  
Transportation

**Hey, West Seattle!**  
Stay Local and Plan Ahead

**As the city reopens, traffic on West Seattle detour routes will continue to increase.**

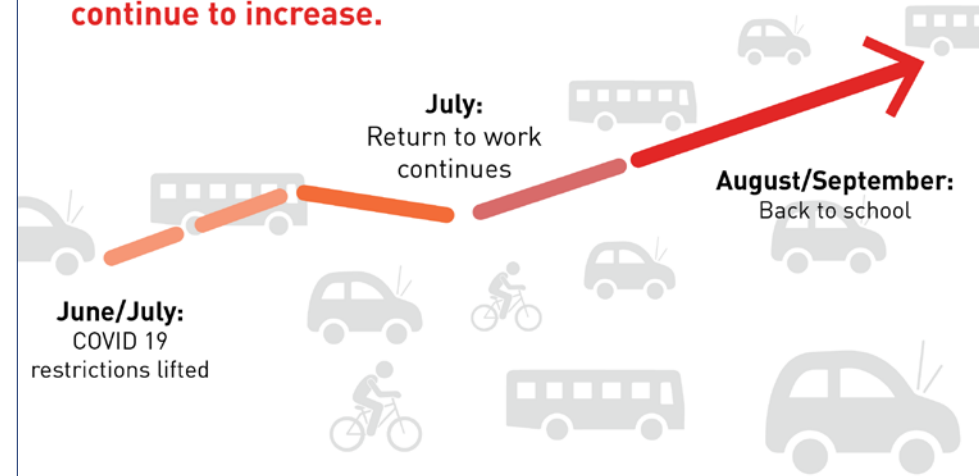

Save time and plan ahead before you leave.

Discover your travel options:

<https://bit.ly/traveloptions206>



# Maxanu imika sameyoynaa

- Ku darista 30,000 saacadood oo basaska loo kordhiyo Galbeedka Seattle laga bilaabo Oktoobar
- Iskaashi aanu la yeelano hey'adaha kale, bulshada, iyo ganacsiyada si loo bixiyo loona dhiiri-geliyo siyaabo kale oo lagu safro
- Dhamaadkii bishii Agostii in dhaafay waxan bilownay barnaamij dhiiri-gelin oo lagu kaashanayo King County Metro si loogu caawiyo bulshada iney wax ka ogaadaan habab kale oo lacag ku dhaqaaleystaan
- Inagoo la shaqeyneyna hey'adaha gobolka dadka shaqaaleeya si loo dhiiri-geliyo in guriga laga shaqeeyo, gawaarida la isla raaco ama bas la doorto, iyo baaskiil raacis



Sal the Salmon wuxuu kuu hayaa talooyin si aad meelaha u aaddo.  
Ka eeg Sal Baraha Bulshada!

# Sida socdaalladaadu yihiin waxey saameyn ku leedahay qof kastaa

Inaad sida aad u socdaasho way adag tahay. Hal socdaal aad beddesho, wax weyn ayey tareysaa!

- Soco, orod, ama mootee
- Raac baska ama taksiga biyaha
- La raac ama faan la wadaag
- Joog kana adeego xaafadda
- Socdaal xilli ka baxsan waqtiga shaqadu badan tahay, ku ekaw jidadka lagu leexdo, si deggan u wad, qof daris ah ahow

➔ Ka raadso webseydkeena talooyinkeena kala duwan ee socdaallada: [bit.ly/traveloptions206](https://bit.ly/traveloptions206)



# Daraasad beddelista buundada

Wes Ducey, SDOT  
Juulay 21, 2021



City of Seattle

# Suurt o-gelnimada beddelaadda Buundada Sare-Kacsan

- Daraasad ayaa la bilaabay Juun oo muddo dheer lagu beddelayo Buundada Galbeedka Seattle
- Filo in marinka wujhaddan kaliya sii ahaan doono mid caqabado badan mustaqbalka
- Ku talo gal in buunada la dayac-tiray ay sii raagi doonto toboneeyo sano
- Tallaabo imika la qaado waxey xaqiijineysaa inaan diyaar u nahay beddelaadda buundada marka waqtigeedu yimaado

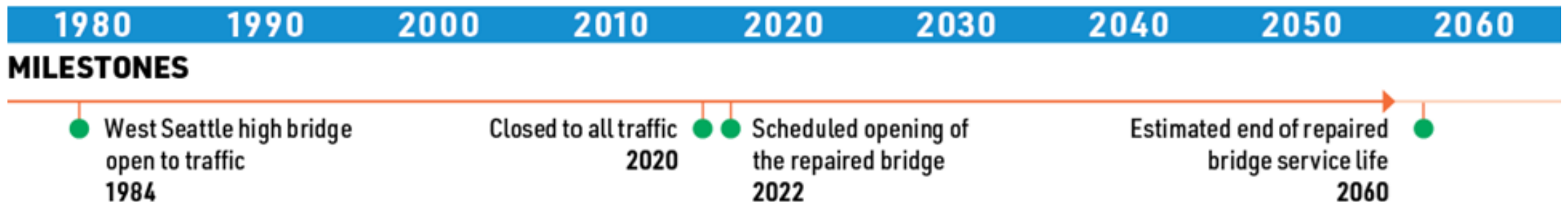



# Maxaa imika loo qorsheynayaa beddelista?

- Raac tilmaamaha Meeyor Durkan si loo dayactiro loona qorsheeyo beddelitaan
- U oggolow magaalada iney si dhaqsi ah uga jawaabto haddii si lama filaan ah xaalad kale oo deg-deg ah timaado
- Garo baahida loo qabo wujhadda, oo ay ku jiraan baaskiillada, lugeeyeyaasha, iyo hababka basaska kala duwan; iyo sidoo kale fursadaha goobaha
- Tan ugu horreysa tallaabooyin badan waa inagoo qorsheyneyna beddelidda buundada xilli ka mida mustaqbalka

# Tallaabooyinka xiga ee howlaha Daraasadda Qorshaha Magaalada

- Ka warbixin qoraal lagu ogaaday daraasadda beddelaadda muddada dheer ee xilliga deyrta 2021
- In si dhow loola shaqeeyo Sound Transit iyo Dekedda Seattle
- Dhameystirka muuqaalka iyo daraasadda suurto-galka dhamaadka 2021
- Booqo webseydkeena si aad warar dheeraad ah u hesho ama talo u dhiibato

## REPLACEMENT PLANNING STUDY SCHEDULE

2021		
June	Q3	Q4
<ul style="list-style-type: none"><li>▪ Launch high bridge replacement planning scope and schedule</li></ul>	<ul style="list-style-type: none"><li>▪ Feasibility findings</li><li>▪ Introduce core concepts</li><li>▪ Draft planning study</li></ul>	<ul style="list-style-type: none"><li>▪ Final planning study</li></ul>

An aerial photograph of a multi-lane highway bridge spanning a city and a body of water. The bridge has several concrete pillars supporting its structure. Traffic is visible on the highway, including a large truck and several cars. In the background, there are industrial buildings, a city skyline, and hills under a cloudy sky. The word "Poll" is overlaid in the center of the image.

# Poll

# Siyaabaha lagula socon karo wararka ugu dabeeya



Nagu casum inaan si muuqaal ah kula kulanno kooxdaada ama hey'addaada



Inoo soo iimeel garee ama na soo wac si aad noola wadaagto fakarkaaga

WestSeattleBridge@seattle.gov ama (206) 400-7511



Booqo webseydkeena si aad isugu qorto helitaanka wararka toddobaad kasta:

[www.seattle.gov/WestSeattleBridge](http://www.seattle.gov/WestSeattleBridge)



Seattle  
Department of  
Transportation

## West Seattle Bridge Weekly Update

Every Friday, we're sending this email to keep you informed about our progress to stabilize the bridge, our efforts to address traffic and mobility, and other items related to the West Seattle High-Rise Bridge closure.

In this week's update:

- [High-Rise Bridge Stabilization update](#)
- [This Weekend: Paving work on 16th Ave SW and Potential Striping on the Low Bridge](#)
- [November 16 Mayor's Virtual West Seattle Bridge Town Hall](#)
- [November 19 Community Task Force Meeting](#)



Temporary work platforms enable crews to do important stabilization work on the West Seattle High-Rise Bridge, and offer a unique view of the Low Bridge.

## High-Rise Bridge Stabilization

Mayor Durkan Observes Progress

Mayor Jenny Durkan visited the West Seattle High-Rise Bridge in the wind and





# Q&A session

Question and Answer

### Welcome to Q&A

Questions you ask will show up here. Only host and panelists will be able to see all questions.

Type your question here...



# Mahadsanid!

[seattle.gov/WestSeattleBridge](https://seattle.gov/WestSeattleBridge)

